

DESCRIPTION		FIRST ISSUE			
REV	DATE	BY	CHKD	APPD	SG
A	25/05/2023	JN	RF/AT		

CDM RESIDUAL RISK

☐ DESIGN BASED HAZARDS ARE ACTIVELY ELIMINATED WHERE PRACTICAL. WHERE HAZARDS ARE NOT ELIMINATED THEY ARE IDENTIFIED BY THIS SYMBOL.

☐ HAZARDS / RISKS THAT SHOULD BE CONSIDERED BY A COMPETENT CONTRACTOR ARE NOT IDENTIFIED

- GENERAL NOTES:
- ALL DIMENSIONS IN MILLIMETRES.
 - LSTC 132kV SEP & LOCATION TO BE CONFIRMED, SUBJECT TO DETAILED CLEARANCE CHECKS.

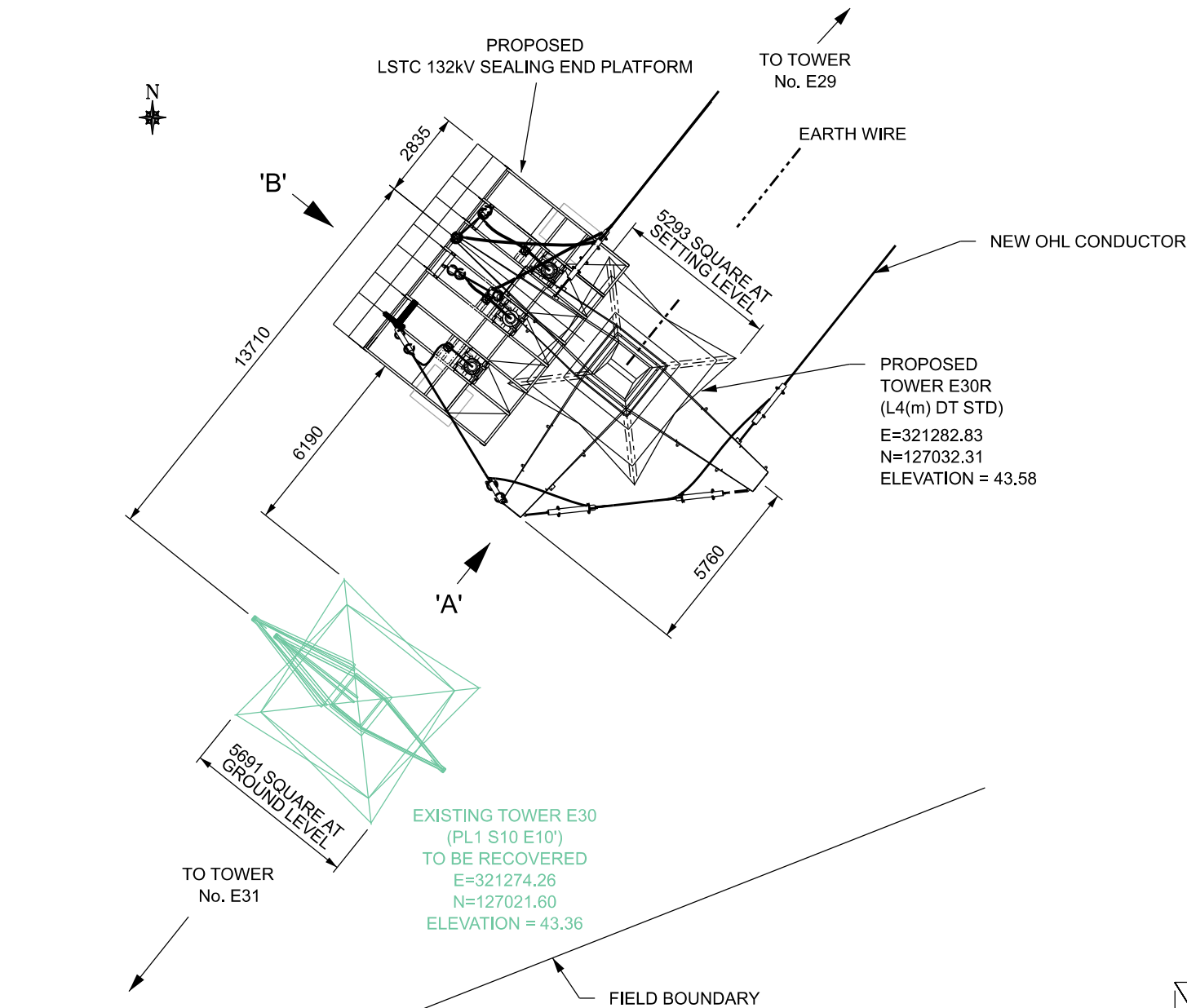

PLAN

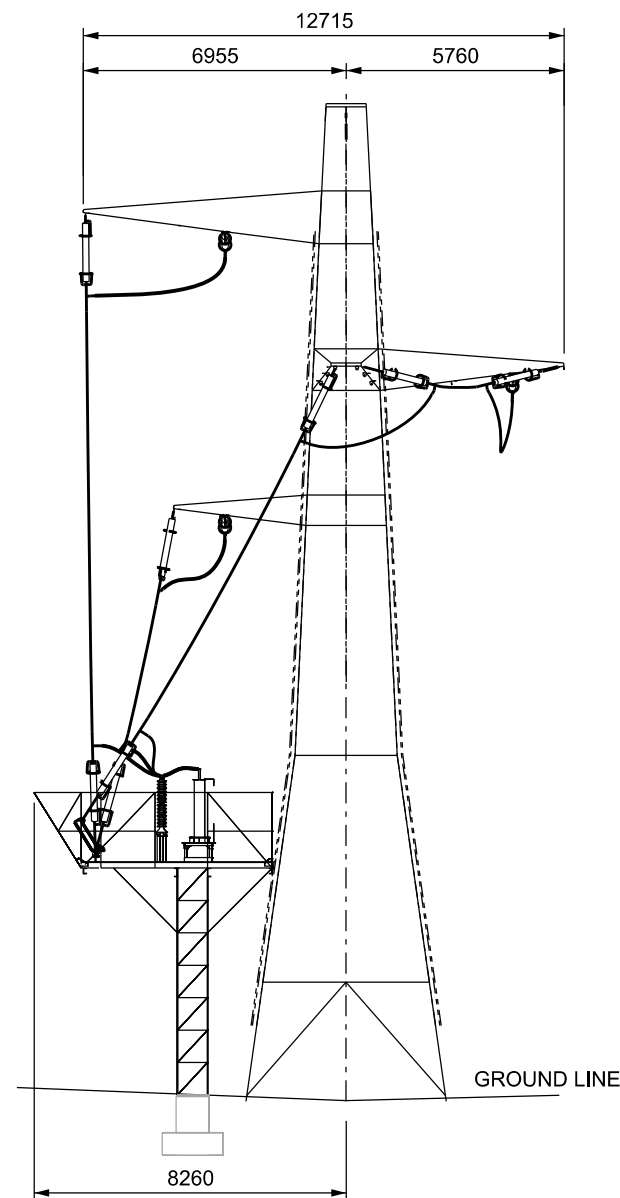

VIEW ON ARROW 'A'
TRANSVERSE ELEVATION

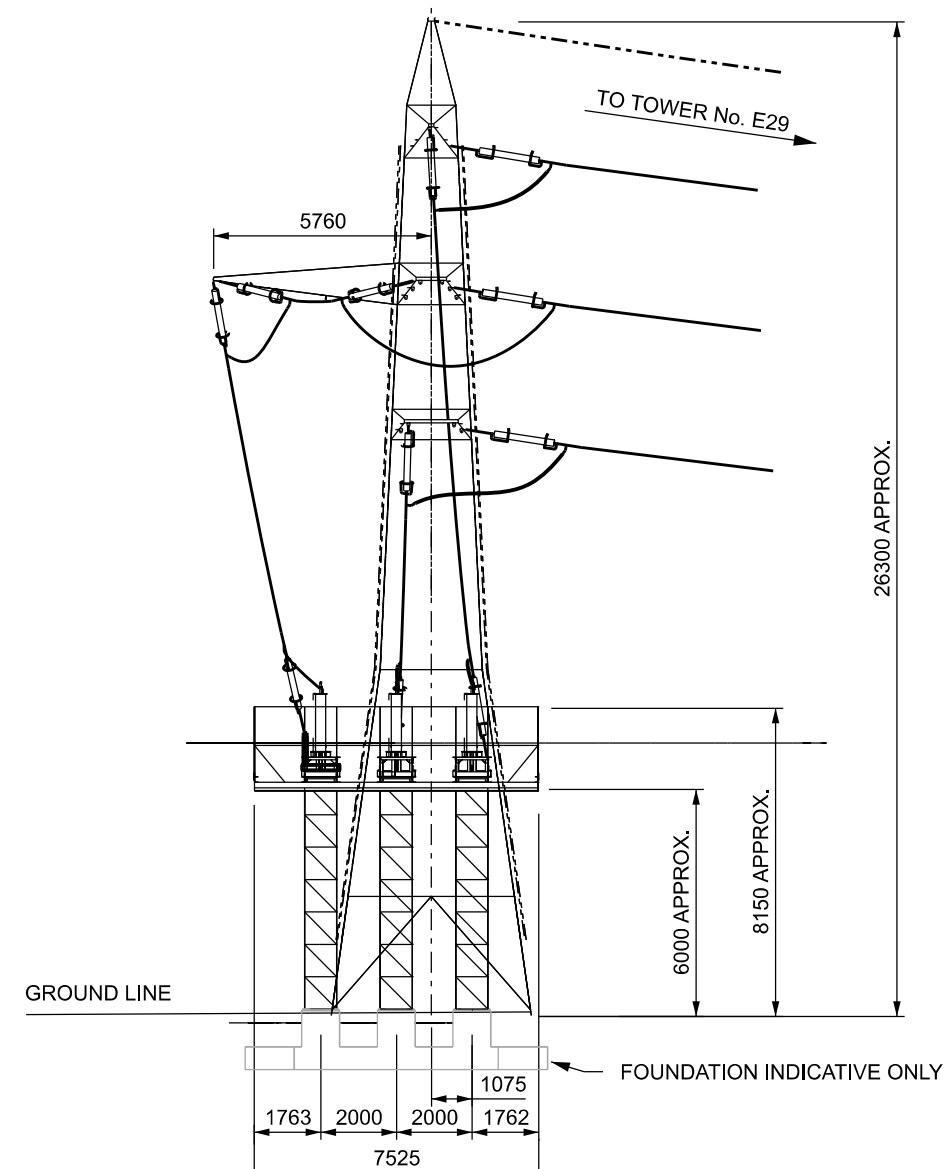

VIEW ON ARROW 'B'
LONGITUDINAL ELEVATION



IF IN DOUBT ASK ENGINEER / DESIGN OFFICE

VIEW CONVENTION
THIRD ANGLE

This drawing is the exclusive property of the client the contents of the drawing must be treated as strictly confidential and must not be disclosed to any third party without the clients written consent. Use only for the purpose for which it was loaned. No copying or reproducing, return on request.

CLIENT

PROJECT

STAPLEGROVE 132kV TERMINATIONS
DETAILED DESIGN

TITLE

PLANNING DRAWING SHOWING PROPOSED
REPLACEMENT TOWER No. E30R
(L4m DT STD HT)
C/W LSTC 132kV SEALING END PLATFORM

LS Transmission Consultancy Limited makes no warranties, express or implied, that compliance with this drawing, or any other document issued by LSTC, would in itself be sufficient to ensure safe systems of work or operation. Users are reminded of their own duties under health and safety legislation.

SCALE 1:200	SHEET No. --	DESIGNED JN
DATE 25/05/2023	CHECKED RF/AT	
DRAWN JN	APPROVED SG	
ORIGINAL SIZE A3	DRAWING NUMBER 23_220816_01	REV A