

- GENERAL NOTES
- DO NOT SCALE THIS DRAWING.
 - THIS DRAWING SHOULD BE READ IN CONJUNCTION WITH THE 132KV CONNECTION DOCUMENT ST-SD2A AND DRAWINGS LISTED BELOW.
 - THIS DRAWING IDENTIFIES THE REQUIREMENTS FOR THE NGED COMPOUND, NGED CONTROL BUILDING AND ASSOCIATED CIRCUIT ENTRY/ES AND VEHICULAR ACCESS. IT DOES NOT DETAIL THE CUSTOMER COMPOUND AND CONTROL BUILDING.
 - DETAILED CIVIL DESIGN WORKS ARE THE RESPONSIBILITY OF THE CUSTOMER, BUT THE INFORMATION PROVIDED ON THIS DRAWING MAY BE INCORPORATED INTO THE CUSTOMERS OVERALL CIVIL SITEWORKS DRAWING AS NECESSARY (ASSUMING THAT THE CUSTOMER HAS CHECKED THE VIABILITY OF THE INFORMATION TO THE PRESENTED SITE CONDITIONS).
 - THE CUSTOMER MUST CARRY OUT SUITABLE GROUND INVESTIGATION AND A FLOOD RISK ASSESSMENT TO ENSURE THE VIABILITY OF THEIR DESIGN.
 - THE CUSTOMER MUST CARRY OUT THEIR OWN STRUCTURAL CALCULATIONS.
 - THE SUPPORT STRUCTURES SHOWN ON THE DRAWING ARE INDICATIVE ONLY. ALTERNATIVE DESIGNS CAN BE SUBMITTED FOR NGED REVIEW.
 - SITE TOPOGRAPHY - THE NGED SUBSTATION COMPOUND SURFACE SHALL BE CONFIGURED SO THAT THERE IS A MAXIMUM GRADIENT OF 1 IN 60 FALL ACROSS THE AREA BUT WHERE A GREATER INCLINE WOULD BE ADVANTAGEOUS, NGED MAY CONSIDER A DIFFERENT VALUE ON A SITE BY SITE BASIS.
 - NGED COMPOUND: 2M MAINTENANCE STRIP AND 1M MIN AROUND NGED CONTROL BUILDING TO BE STRIPPED OFF 225MM TOP SOIL AND BACK FILLED TO FINISHED SITE LEVEL WITH 150MM THICK TYPE 1 SUB BASE AND FINISHED WITH 75MM LAYER OF 20MM SINGLE SIZED GRANITE CHIPPINGS. TERRAM T1300 GEOTEXTILE TO BE PLACED BETWEEN THE TYPE 1 SUB BASE AND GRANITE CHIPPINGS LAYERS.
 - THE CUSTOMER IS TO INSTALL SUFFICIENT SURFACE WATER DRAINAGE TO PREVENT A POTENTIAL BUILD-UP OF GROUND WATER. THIS DRAINAGE SYSTEM SHOULD CONVEY WATER TO A SUITABLE POINT OF DISPOSAL.
 - THE CUSTOMER IS TO FULLY DETAIL THE ACCESS ROAD CONSTRUCTION AND ALL CABLE ROUTES WITH ASSOCIATED DUCTING AND CABLE TROUGHS.
 - NO THIRD PARTY UTILITY ASSETS ARE TO BE LOCATED BENEATH/WITHIN THE NGED COMPOUND WITHOUT PRIOR APPROVAL.
 - ALL NGED SITES ARE TO HAVE A CATEGORY 1 SECURITY LEVEL AT 132kV.
 - FOR MAINS WATER AND FOUL WATER SERVICES, SANITARY SERVICES SHALL BE PROVIDED IN ACCORDANCE WITH ST-SD2A.
 - THE MEANS OF OHL TERMINATION IS SUBJECT OHL CONNECTION DESIGN ANALYSIS FOR INSTANCE ANCHOR BLOCKS MAY BE DEPLOYED IN PREFERENCE TO CHAIR STRUCTURES.
 - STEEL TOWER CABLE MASTS HAVE NOT BEEN CONSIDERED IN THE DESIGN - A SITE SPECIFIC 132KV SUBSTATION LAYOUT DESIGN WILL NEED TO BE PREPARED TO ACCOMMODATE THESE MASTS.

REFERENCE DRAWINGS			
DRG No.	DRG REV	DRG TITLE	DRG STATUS
GC50020-3	0	SITE LAYOUT - CABLE CONNECTION (PLAN VIEW)	INFORMATION ONLY
GC50020-4	0	SITE LAYOUT - CABLE CONNECTION (ELEVATION VIEWS)	INFORMATION ONLY
GC50020-5	0	TYPICAL NGED CONTROL BUILDING LAYOUT - LOOP CONNECTION	INFORMATION ONLY
GC50020-6	0	S.D. -132KV LOOP IN-LOOP OUT INCOMERS	INFORMATION ONLY
GC50020-8	0		CONTROL BUILDING LAYOUT CABLE MESH CONNECTION

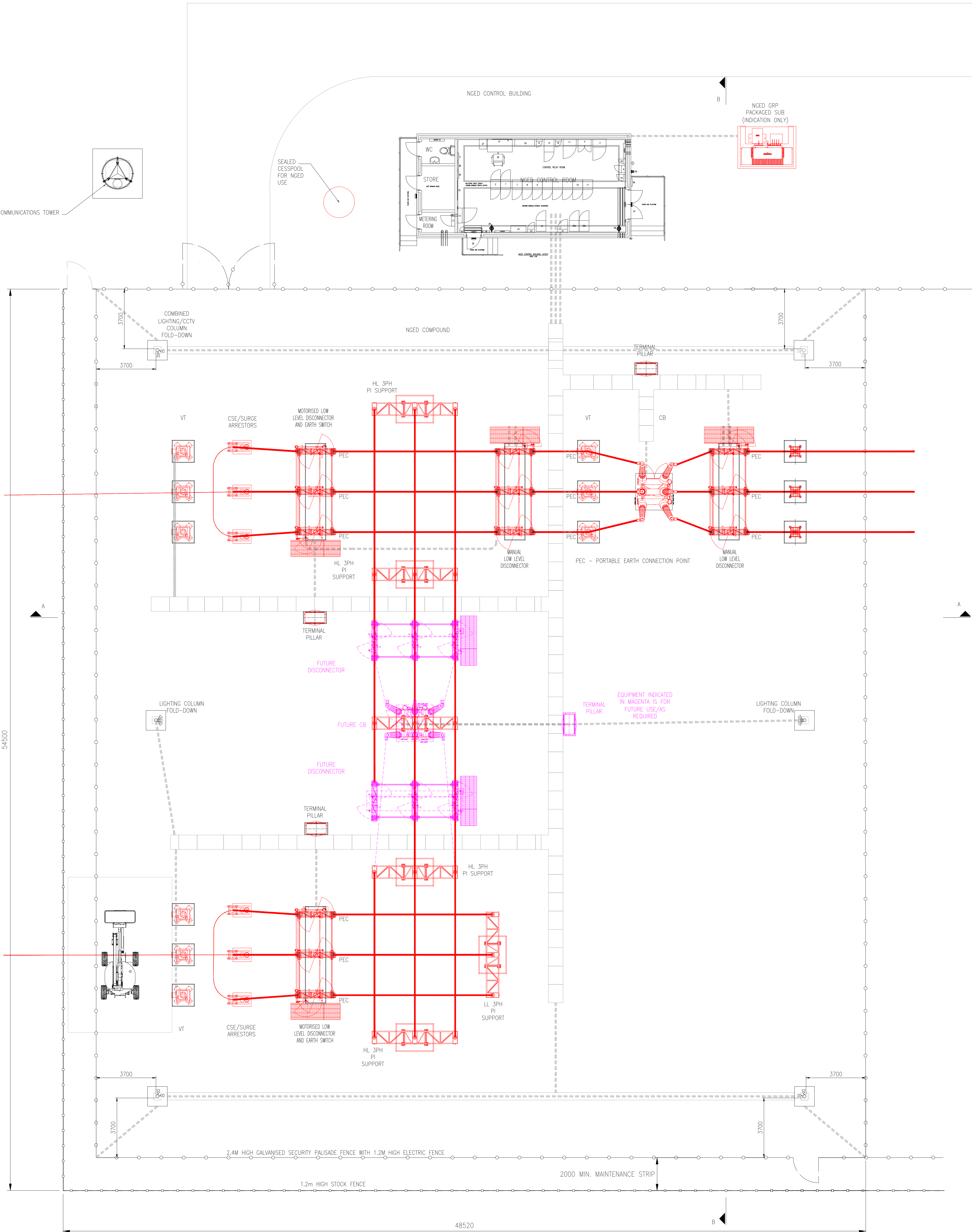

SITE LAYOUT

Rev	Drawn	Chk'd	App'd	Date	Revision Note
0	PJB	KRS	CH	03.11.23	CONTROL BUILDING PANEL LAYOUT REVISED.
0	PJB	KRS	CH	03.11.23	ORIGINAL ISSUE

nationalgrid Electricity Distribution		Engineering Design Department (East Midlands) Pegasus Business Park, Castle Donington, DE74 2TU.	
Title:	NGED 145KV STANDARDS LOOP CONNECTION PLANT LAYOUT LOOP IN SUBSTATION WITH AN UG CABLE CONNECTION - LAYOUT	Scale:	1:100 @A0
Drw. No.	GC50020-3	Rev No.	A

DO NOT SCALE DRAWING. ONLY USE STATED DIMENSIONS. IF IN DOUBT, ASK.
ALL RIGHTS ARE RESERVED TO NED (EAST MIDLANDS) PLC. NO PART OF THIS DRAWING MAY BE REPRODUCED OR TRANSMITTED IN ANY FORM OR BY ANY MEANS, INCLUDING PHOTOCOPYING AND RECORDING, OR STORED IN A RETRIEVAL SYSTEM OF ANY NATURE, WITHOUT PERMISSION.